



SUCCULENT #1



1

TRIM ALL OF THE PIECES AS SHOWN ON THE PATTERN FROM A SELECTION OF CARD STOCK COLORS



2

CURL 2 CENTER PIECES WITH EDGE OF SCISSORS

SUCCULENT 1: CROSS THE SLITS AND GLUE TO FORM CUP



3

GLUE THE THREE OF EACH SIZE TOGETHER AT CROSSED TIPS. GLUE TWO CENTER PIECES



4

STACK AND GLUE IN ORDER OF SIZE



5

CUT PIECE OF FLORAL WIRE AND CURL END



6

GLUE TO BACK OF SUCCULENT



SUCCULENT #2



7

**SUCCULENT 2:
CURL ALL
LEAVES WITH
EDGE OF
SCISSORS**



8

**GLUE TOGETHER
TWO OF EACH SIDE
WITH ONE CENTER
UNGLUED**



9

**STACK AND GLUE IN SIZE ORDER. ADD
SINGLE CENTER WITH LEAVES FOLDED UP**



10

**GLUE CURLED END PIECE OF FLORAL
WIRE TO BACK OF SUCCULENT**



SUCCULENT #3



19
SUCCULENT 5: CURL TIPS OF LEAVES IN TWO DIRECTIONS WITH EDGE OF SCISSORS



20
GLUE THREE SMALLEST PIECES ONTO WIRE



21
GLUE LARGER THREE LEAVES AROUND WIRE





SUCCULENT #4





SUCCULENT #5

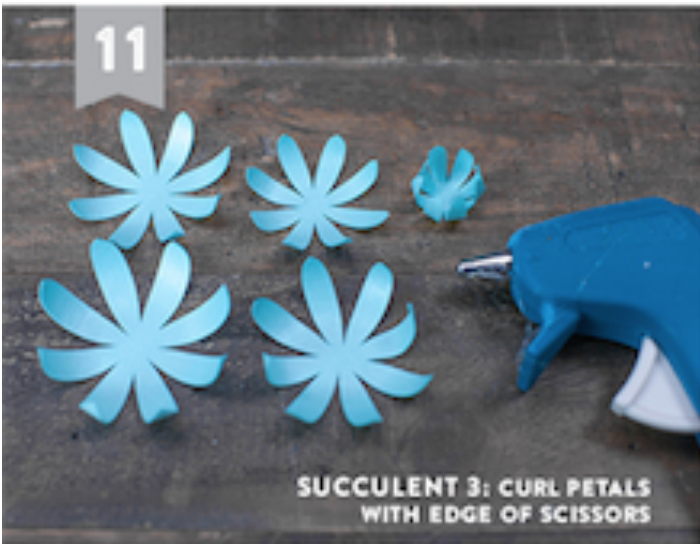



SUCCULENT #6





SUCCULENT #7

